

LHK Series (NEW) 焊片/焊针型铝电解电容器长寿命品

Long Life Aluminum Electrolytic Capacitor of Lug / Snap-in Type

- RoHS指令对应品 RoHS compliance
- 105°C 5000小时 105°C 5000hours
- 适用于专业电源、变频器等领域
Used in professional power supplies and frequency etc.



主要技术性能 Specifications

使用温度范围 Operating Temperature Range	-40 ~ +105°C	-25 ~ +105°C												
额定电压范围 Rated Voltage Range	250V DC	315~450V DC												
标称电容量允许偏差 (120Hz, 20°C) Capacitance Tolerance	± 20% (120Hz, 20°C)													
漏电流 Leakage Current	$I \leq 3\sqrt{CV}$ (μA) 或 1.5mA 取较大值 (20°C, 施加额定电压5分钟后) $I \leq 3\sqrt{CV}$ (μA) or 1.5mA Whichever is greater (20°C, after 5 minutes application of rated voltage)													
损耗角正切值 Dissipation Factor (120Hz, 20°C) tg δ	<table border="1"> <thead> <tr> <th>W.V.</th> <th>250</th> <th>315</th> <th>350</th> <th>400</th> <th>450</th> </tr> </thead> <tbody> <tr> <td>tg δ</td> <td>0.15</td> <td>0.15</td> <td>0.15</td> <td>0.15</td> <td>0.20</td> </tr> </tbody> </table> <p>容量大于 1000 μF 者, 每增加 1000 μF, 其损耗角正切值增加 0.02 For capacitance exceeding 1000 μF, add 0.02 per increment of 1000 μF</p>		W.V.	250	315	350	400	450	tg δ	0.15	0.15	0.15	0.15	0.20
W.V.	250	315	350	400	450									
tg δ	0.15	0.15	0.15	0.15	0.20									
耐久性 Load Life	<p>+105°C 施加额定电压5000小时, 恢复24小时后, 电容器应满足要求 After applying rated voltage for 5000 hours at +105°C and then resumed 24 hours. The capacitor shall meet the following limits.</p> <table border="1"> <tr> <td>电容量变化率 Capacitance Change</td> <td>≤ ± 20% 初始测量值 ≤ ± 20% of Initial value</td> </tr> <tr> <td>漏电流值 Leakage</td> <td>≤ 规定值 ≤ The specified value</td> </tr> <tr> <td>损耗角正切值 Dissipation Factor</td> <td>≤ 2 倍规定值 ≤ 200% of the specified value</td> </tr> </table>		电容量变化率 Capacitance Change	≤ ± 20% 初始测量值 ≤ ± 20% of Initial value	漏电流值 Leakage	≤ 规定值 ≤ The specified value	损耗角正切值 Dissipation Factor	≤ 2 倍规定值 ≤ 200% of the specified value						
电容量变化率 Capacitance Change	≤ ± 20% 初始测量值 ≤ ± 20% of Initial value													
漏电流值 Leakage	≤ 规定值 ≤ The specified value													
损耗角正切值 Dissipation Factor	≤ 2 倍规定值 ≤ 200% of the specified value													
高温放置 Shelf Life	<p>+105°C, 1000 小时, 然后加额定电压按照 JISC 5101-4 第 4.1 项规定预处理后测量。 After storage for 1000 hours at +105°C, the capacitor shall be preconditioned by applying voltage according to Item 4.1 of JISC 5101-4.</p> <table border="1"> <tr> <td>电容量变化率 Capacitance Change</td> <td>≤ ± 15% 初始测量值 ≤ ± 15% of Initial measured value</td> </tr> <tr> <td>漏电流值 Leakage</td> <td>≤ 规定值 ≤ The specified value</td> </tr> <tr> <td>损耗角正切值 Dissipation Factor</td> <td>≤ 1.5 倍规定值 ≤ 150% of the specified value</td> </tr> </table>		电容量变化率 Capacitance Change	≤ ± 15% 初始测量值 ≤ ± 15% of Initial measured value	漏电流值 Leakage	≤ 规定值 ≤ The specified value	损耗角正切值 Dissipation Factor	≤ 1.5 倍规定值 ≤ 150% of the specified value						
电容量变化率 Capacitance Change	≤ ± 15% 初始测量值 ≤ ± 15% of Initial measured value													
漏电流值 Leakage	≤ 规定值 ≤ The specified value													
损耗角正切值 Dissipation Factor	≤ 1.5 倍规定值 ≤ 150% of the specified value													
执行标准	JIS C - 5101 (IEC60384-4)													

外形图及尺寸 Case size table

单位: mm

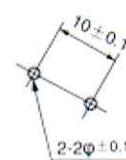
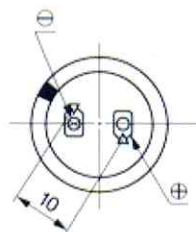
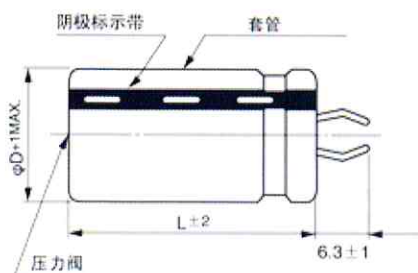

(基板孔尺寸)

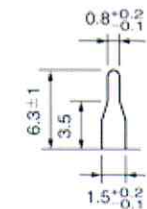

(端子形状)

LHK Series (NEW)

■ 标称电容量、额定电压、额定纹波电流及外形尺寸对应表
Nominal capacitance, rated voltage, rated ripple current and case size table

WV Parameter ΦD × L(mm)	250V		315V		350V		400V		450V	
	Size	I	Size	I	Size	I	Size	I	Size	I
39									22×25	0.37
47									22×30	0.40
56							22×25	0.51	22×35	0.47
									25×25	0.47
68							22×30	0.56	22×40	0.53
							25×25	0.56	25×30	0.53
82			22×25	0.64	22×25	0.64	22×35	0.64	22×45	0.56
							25×25	0.64	25×35	0.56
									30×25	0.56
100			22×30	0.69	22×30	0.69	22×35	0.69	22×50	0.64
							25×25	0.69	25×30	0.64
									30×30	0.64
120			22×30	0.75	22×35	0.69	22×40	0.75	25×45	0.72
			25×25	0.75	25×30	0.75	25×35	0.75	30×30	0.72
							30×25	0.75		
150			22×35	0.82	22×40	0.75	22×50	0.82	25×50	0.79
			25×30	0.82	25×30	0.82	25×40	0.82	30×40	0.79
			30×25	0.82	30×25	0.82	30×30	0.82	35×30	0.79
180	22×30	0.90	22×40	0.90	22×45	0.82	25×45	0.90	30×45	0.87
	25×25	0.90	25×35	0.90	25×35	0.90	30×35	0.90		
			30×25	0.90	30×30	0.90	35×25	0.90		
220	22×30	1.00	22×45	1.00	22×50	0.90	25×50	1.00	30×50	1.00
	25×25	1.00	25×40	1.00	25×40	1.00	30×40	1.00		
			30×30	1.00	30×30	1.00	35×30	1.00		
270	22×35	1.10	25×45	1.10	25×50	1.00	30×45	1.10	35×45	1.19
	25×30	1.10	30×35	1.10	30×35	1.10	35×35	1.10		
	30×25	1.10	35×30	1.10	35×30	1.10				
330	22×40	1.20	25×50	1.20	30×45	1.10	30×50	1.20	35×50	1.38
	25×35	1.20	30×40	1.20	35×35	1.20	35×40	1.20		
	30×25	1.20	35×30	1.20						

外形尺寸Size : φD×L(mm)
I~ 额定纹波电流Rated ripple current : (A , 105°C.120Hz)

LHK Series (NEW)

- 标称电容量、额定电压、额定纹波电流及外形尺寸对应表
Nominal capacitance, rated voltage, rated ripple current and case size table

WV Parameter φD × L(mm)	250V		315V		350V		400V		450V	
	Size	I	Size	I	Size	I	Size	I	Size	I
390	22×45	1.30	30×45	1.30	30×50	1.30	35×45	1.30		
	25×40	1.30	35×35	1.30	35×40	1.30				
	30×30	1.30								
470	25×45	1.40	30×50	1.40	35×40	1.40	35×50	1.40		
	30×35	1.40	35×40	1.40						
	35×30	1.40								
560	25×50	1.50	35×45	1.50	35×50	1.50				
	30×35	1.50								
	35×30	1.50								
680	30×45	1.70	35×50	1.70						
	35×35	1.70								
820	30×50	2.00								
	35×40	2.00								
1000	35×45	2.20								
1200	35×50	2.30								

外形尺寸Size : φD×L(mm)

I ~ 额定纹波电流Rated ripple current : (A , 105°C.120Hz)